

Why Contraflow?



The principal benefit of a contraflow operation is the ability to use the maximum number of highway lanes possible for evacuating people from a threatened area. It's a way to handle

the additional traffic anticipated as Florida residents and visitors leave a coastal area in advance of a hurricane.

One-way or contraflow plans are established for certain expressways and interstates in Florida. When the decision is made to activate a contraflow, sections of these highways are set up to route traffic in one direction, heading away from the approaching storm.

What to Expect



The ultimate decision on a contraflow rests with the Governor. If local and state officials determine that a contraflow is necessary, the Florida Division of Emergency Management, Florida Department of Transportation (FDOT) and the Florida Highway Patrol (FHP) will begin preparing the route. The lanes to be reversed will be closed to incoming traffic and no vehicles will be permitted on the usual entry ramps. Motorists who normally travel these lanes will be diverted to alternate routes.

The FHP will conduct the contraflow operation. Be sure to obey all temporary traffic markers and follow the direction of the law enforcement officers along the route. A contraflow is designed to begin at a certain point, typically at a paved crossover in the highway median. It concludes at a predetermined location where the traffic on the reversed lanes is merged on to another highway. There you will be able to seek temporary shelter locally or continue traveling to another destination.

Getting Information

For traffic information in Florida, dial 511 or visit the Web site www.fl511.com. Traffic conditions and information on roads closed due to crashes can also be obtained from the FHP's Traffic Incident Web site, www.fhp.state.fl.us/traffic.

During contraflows, the FDOT will provide traffic and evacuation information on the 511 traveler information system.



Another information source is highway advisory radio. Watch for the roadside signs that direct you to tune your radio to the designated frequency to hear the alert. For those with Citizens Band (CB) radios, tune to Channel 19 for information.

Portable and fixed message signs will display traffic information and instructions along the contraflow route.

Emergency Alert System radio stations broadcast advisories you can receive along many of Florida's highways. Tune to these stations for weather alerts.

Important Tips

Because of the way they are structured, contraflow routes restrict your travel choices. You will find that many interchanges and exits will be closed, and that contraflow traffic will be directed to predetermined points - with no exceptions. This will limit the options you have to travel as you may have intended.



Remember that a contraflow plan may not reduce the travel time to your destination, or the amount of traffic congestion you encounter along the way - especially if you delay your departure. In fact, traffic may be flowing much more smoothly on roads other than interstates. For more flexibility in your evacuation planning, leave earlier and select an alternate route to your destination.

Other Things to Keep in Mind

- Before leaving, fill your vehicle with fuel.
- Use service plazas and rest areas for brief stops. Food and fuel supplies may be limited, and law enforcement personnel will ensure that traffic keeps moving.
- State law requires that travel lanes be kept clear. If your vehicle becomes disabled and you are stranded, the Road Ranger Service Patrols are instructed to push your car to the unpaved shoulder of the road. Road Rangers will assist in arranging transportation to the next interchange.
- If you are involved in a crash, remove all vehicles from the travel lanes as quickly as possible. If you are unable to move your vehicle, seek help from other motorists. Because law enforcement services will be generally limited to emergencies, drivers are urged to exchange the following information: driver's name, address, and vehicle registration number, along with the insurance carrier's name.
- For *incidents involving injuries* that require immediate medical attention, please wait for emergency responders away from traffic.



Contact Information

Florida Highway Patrol Dial *FHP
Florida DOT 1-866-374-3368
Florida Emergency Information 1-800-342-3557
American Red Cross 1-866-438-4636



On the Web

For more information on contraflow plans and their use on Florida highways, visit www.OneWayFlorida.org.



Motorist Advisory

CONTRA FLOW

Plan for One-Way Evacuation of Interstate 75—Alligator Alley North

A Publication of



Florida Highway Patrol



Florida Department of Transportation



Florida Division of Emergency Management

Contraflow Route for I-75 Alligator Alley Northbound

The northbound contraflow route for I-75's Alligator Alley is available for coastal residents evacuating west. It begins at U.S. 27 and continues north for 101 miles, ending near Fort Myers.

If this contraflow plan is activated, all southbound I-75 traffic in Fort Myers will exit at SR 876 (Exit 131). Southbound traffic already past this exit will be allowed to continue, but all southbound on-ramps will be closed. This will allow reversal of the southbound lanes so that all traffic will flow north along the I-75 contraflow route.

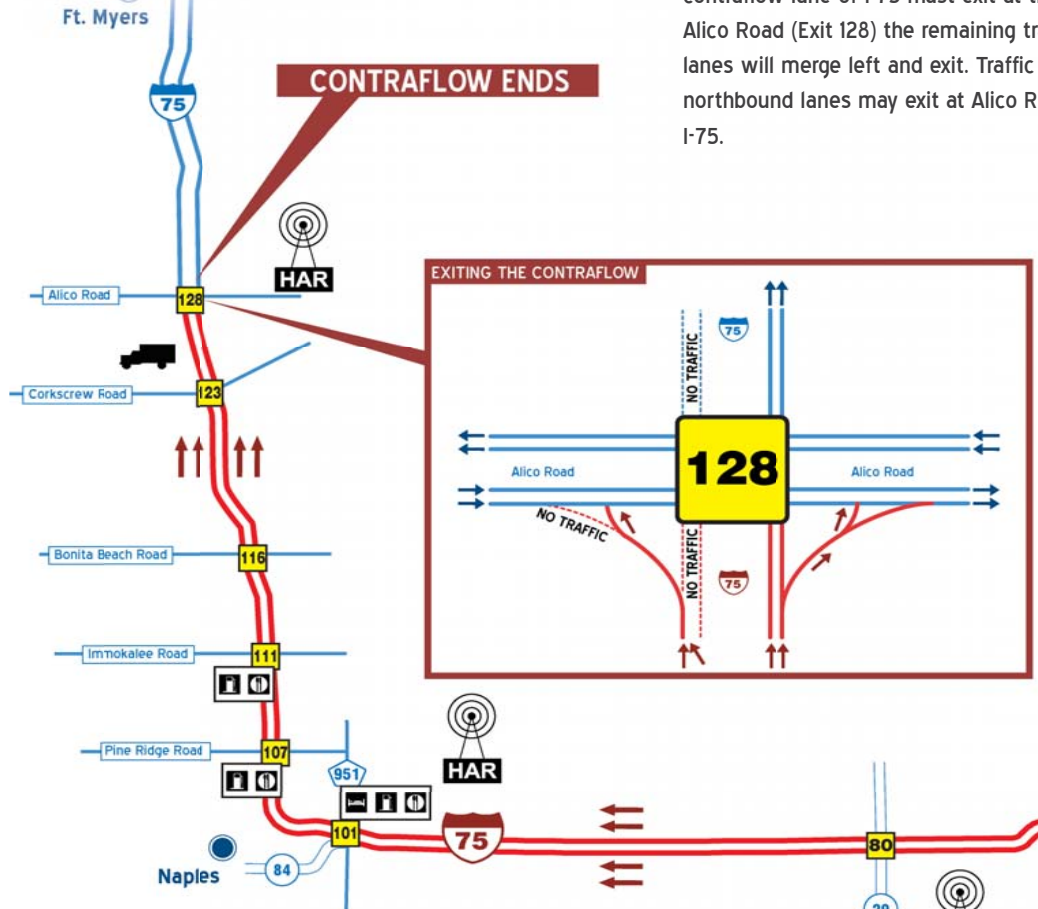

Alternate Route

Motorists seeking an alternate route can use SR 80 to the north or U.S. 41 (Tamiami Trail), which is south of I-75.

Entering the Contraflow

The northbound I-75 contraflow route begins at the U.S. 27 interchange. The traffic in the left-hand northbound lane is directed to a paved crossover in the median and transitions to the contraflow side of the highway. The right-hand northbound lane of traffic proceeds through the interchange. Northbound I-75 is closed to U.S. 27 traffic.

Exiting the Contraflow

At Corkscrew Road (Exit 123) traffic in the left-hand contraflow lane of I-75 must exit at that interchange. At Alico Road (Exit 128) the remaining traffic in contraflow lanes will merge left and exit. Traffic in the regular northbound lanes may exit at Alico Road or continue on I-75.

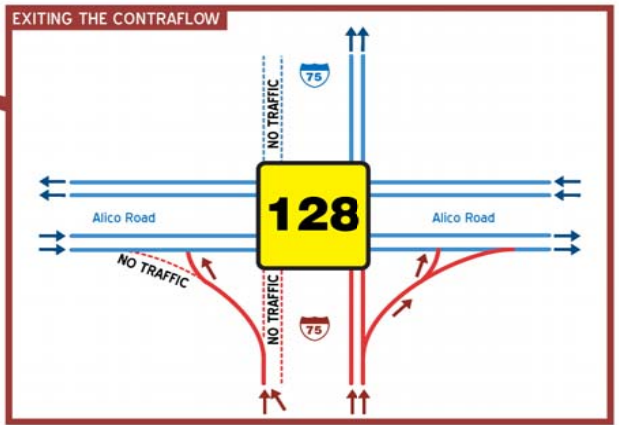

CONTRAFLOW LEGEND

Highway Advisory Radio	CB Wizard Alert
Interchange (No exit allowed)	Lodging
Interchange (Exit allowed)	Fuel
CLOSED Rest Area or Recreation Area	Food

NOTE: The rest area at Mile Post 63 will be open to cars only. All other vehicles will be directed to the recreation area at Mile Post 70.

On the Radio

Tune to the following radio stations for hurricane advisories and other important information from the Florida Public Radio Network.

- Fort Myers WGPU, 90.1 FM
- Miami WLRN, 91.3 FM
- West Palm Beach WXEL, 90.7 FM

Local Agency Phone Numbers

- American Red Cross
- Broward County Chapter (Plantation)954-797-3800
 - Collier County Chapter (Naples)239-596-6868
 - Collier County Emergency Management..... 239-774-8444
 - Broward County Emergency Management954-831-3900
 - FDOT District 1 (Fort Myers)1-800-292-3368
 - FDOT District 4 (Fort Lauderdale).....1-866-336-8435

Facilities Along the Route

Recreation areas at Mile Post 31, 32, 38 and 40 will be closed. At Mile Post 35, the rest area will be open to all traffic. The rest area at Mile Post 63 is open to automobiles only. Trucks, RVs and vehicles towing trailers will be directed to the recreation area at Mile Post 70, which will have temporary facilities.

Motorist aid call boxes are available for those needing assistance, and cellular phone calls to *FHP are free.

Food and fuel are available at CR 833 (Exit 49). Vehicles may return to I-75 northbound, but will be directed to enter from the regular northbound side of the interstate.

Evacuating vehicles on both sides of the contraflow route may exit at SR 29. Vehicles may re-enter I-75 from either side of the highway.

At CR 951 (Exit 101), Pine Ridge Road (Exit 107), Immokalee Road (Exit 111), and Bonita Beach Road (Exit 116), traffic from either side of the contraflow route may exit I-75 for food and fuel. There is no re-entry of the interstate from the contraflow side.

